



ITEMS SHOWN ARE DIAGRAMMATIC AND ARE SHOWN FOR THE LIMITED PURPOSE OF INDICATING PROPOSED LOCATIONS OF THE DESIGN. CONTRACTORS SHALL PROVIDE WORK IN ACCORDANCE WITH ALL APPLICABLE CODES AND REGULATIONS REQUIRED BY THE AUTHORITY HAVING JURISDICTION. CONTRACTOR SHALL COORDINATE THE INSTALLATION OF NEW SYSTEMS WITH EXISTING SYSTEMS.

Thomas McInerney Architect reserves the right to determine a fair and equitable solution to any problems, mistakes, oversights or hidden damage. Please do not hesitate to phone our office at 319-331-0365, especially immediately upon discovery a conflict with the Scope of Work.

Please do not instinctively produce a solution or proceed with work that would result in a change order requiring reimbursement by the owner.

Any solutions outside this policy shall be with prior approval and will be at the franchisee's or contractor's expense.

Project: Addition to the **JAVA HOUSE**
207 Washington
Iowa City, Iowa
Project number: 11.24

Note: © COPYRIGHT UNAUTHORIZED COPYING, DISCLOSURE OR CONSTRUCTION WITHOUT WRITTEN PERMISSION BY THOMAS MCINERNEY, ARCHITECT, IS PROHIBITED.

Issue date:	Date	Description
	2011.09.20	Permit Application

I hereby certify that the portion of this technical submission described herein was prepared by me or under my direct supervision and responsible charge. I am a duly registered Architect under the laws of the State of Iowa.
THOMAS A. MCINERNEY
9/20/2011
Signature: _____ Date: 9/20/2011
Registration expires: June 30, 2013 Date issued: JANUARY 2001
Pages or sheets covered by this seal: **A-101**

Sheet Title: **PLANS AND DETAILS**
Sheet Number: **A-101**

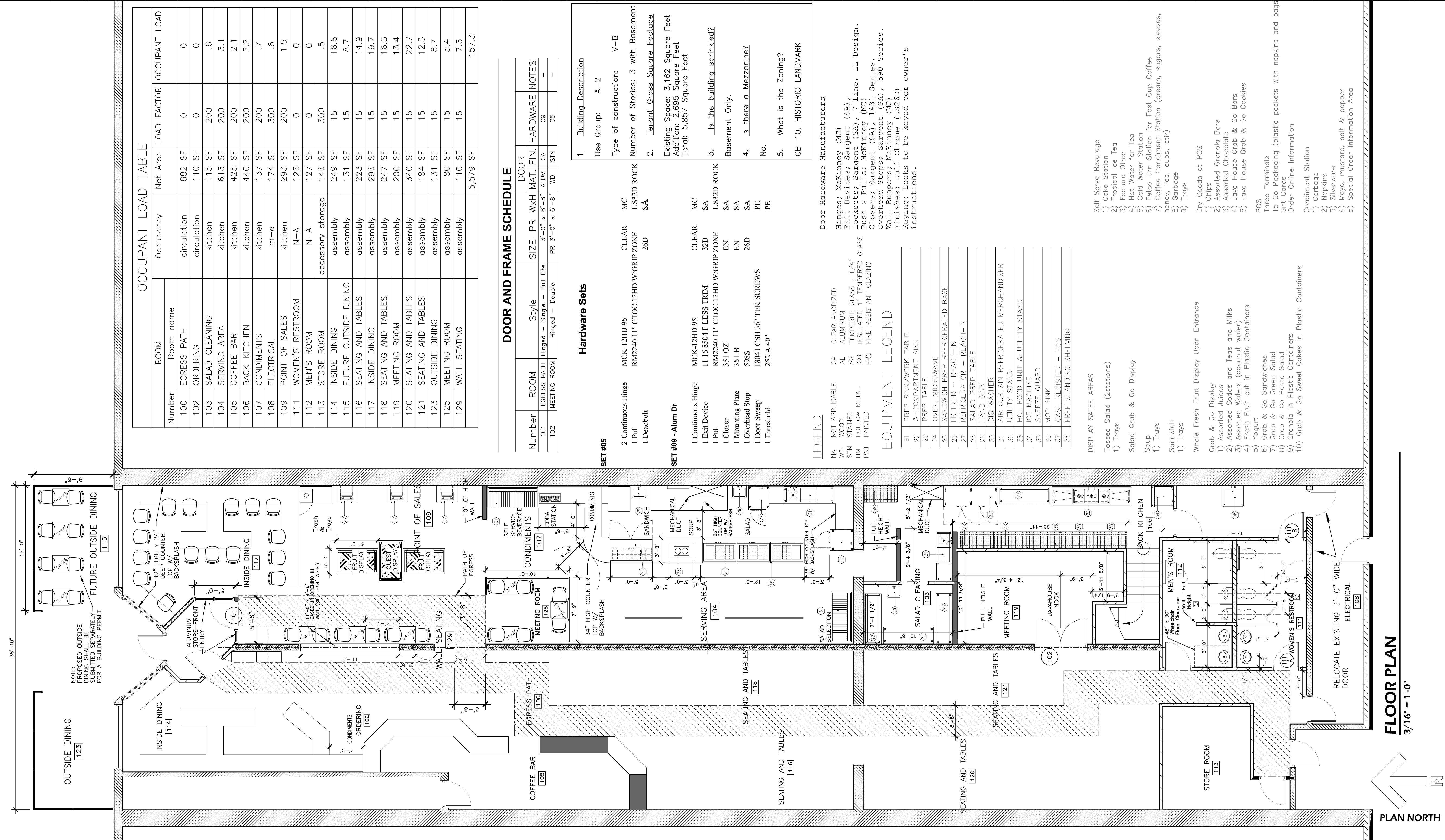

OCCUPANT LOAD TABLE

ROOM	Room name	Occupancy	Net Area	LOAD FACTOR	OCCUPANT LOAD
100	EGRESS PATH	circulation	682 SF	0	0
102	ORDERING	circulation	110 SF	0	0
103	SALAD CLEANING	kitchen	115 SF	200	.6
104	SERVING AREA	kitchen	613 SF	200	3.1
105	COFFEE BAR	kitchen	425 SF	200	2.1
106	BACK KITCHEN	kitchen	440 SF	200	2.2
107	CONDIMENTS	kitchen	137 SF	200	.7
108	ELECTRICAL	m-e	174 SF	300	.6
109	POINT OF SALES	kitchen	293 SF	200	1.5
111	WOMEN'S RESTROOM	N-A	126 SF	0	0
112	MEN'S ROOM	N-A	127 SF	0	0
113	STORE ROOM	accessory storage	146 SF	300	.5
114	INSIDE DINING	assembly	249 SF	15	16.6
115	FUTURE OUTSIDE DINING	assembly	131 SF	15	8.7
116	SEATING AND TABLES	assembly	223 SF	15	14.9
117	INSIDE DINING	assembly	296 SF	15	19.7
118	SEATING AND TABLES	assembly	247 SF	15	16.5
119	SEATING AND TABLES	assembly	200 SF	15	13.4
120	SEATING AND TABLES	assembly	340 SF	15	22.7
121	SEATING AND TABLES	assembly	184 SF	15	12.3
123	OUTSIDE DINING	assembly	131 SF	15	8.7
125	MEETING ROOM	assembly	80 SF	15	5.4
129	WALL SEATING	assembly	110 SF	15	7.3
			5,579 SF		157.3

DOOR AND FRAME SCHEDULE

Number	ROOM	Style	SIZE-PR	WxH	MAT. FIN.	DOOR	HARDWARE	NOTES
101	EGRESS PATH	Hinged - Single	- Full Lite	3'-0" x 6'-8"	ALUM	CA	09	-
102	MEETING ROOM	Hinged - Double	-	PR 3'-0" x 6'-8"	WD	STN	05	-

Hardware Sets

- SET #05**
- 2 Continuous Hinge MCK-12HD 95 CLEAR MC
 - 1 Pull RM2240 11" CTOC 12HD W/GRIP ZONE 26D US32D ROCK
 - 1 Deadbolt SA
- SET #09 - Alum Dr**
- 1 Continuous Hinge MCK-12HD 95 CLEAR MC
 - 1 Exit Device 11 16 8304 F LESS TRIM 32D SA
 - 1 Pull RM2240 11" CTOC 12HD W/GRIP ZONE 26D US32D ROCK
 - 1 Closer 351 OZ EN SA
 - 1 Mounting Plate 351-B EN SA
 - 1 Overhead Stop 59MS SA
 - 1 Door Sweep 18041 CSB 36" TEK SCREWS 26D PE
 - 1 Threshold 252 A 40" PE
- SET #10 - HISTORIC LANDMARK**
- CB-10, HISTORIC LANDMARK

LEGEND

- NA NOT APPLICABLE
- CA CLEAR ANODIZED
- AL ALUMINUM
- SG STAINED
- ISG INSULATED 1" TEMPERED GLASS
- HM HOLLOW METAL
- FRG FIRE RESISTANT GLAZING
- PMT PAINTED

EQUIPMENT LEGEND

- 21 PREP SINK/WORK TABLE
- 22 3-COMPARTMENT SINK
- 23 PREP TABLE
- 24 OVEN, MICROWAVE
- 25 SANDWICH PREP REFRIGERATED BASE
- 26 FREEZER - REACH-IN
- 27 REFRIGERATOR - REACH-IN
- 28 SALAD PREP TABLE
- 29 HAND SINK
- 30 DISHWASHER
- 31 AIR CURTAIN REFRIGERATED MERCHANDISER
- 32 UTILITY STAND
- 33 HOT FOOD UNIT & UTILITY STAND
- 34 ICE MACHINE
- 35 SNEEZE GUARD
- 36 MOP SINK
- 37 CASH REGISTER - POS
- 38 FREE STANDING SHELVING

DISPLAY SATEE AREAS

- Tossed Salad (2stations)
- Trays
- Solid Grab & Go Display
- Soup
- Trays
- Sandwich
- Trays
- Whole Fresh Fruit Display Upon Entrance
- Grab & Go Display
- Assorted Juices
- Assorted Sodas and Teas and Milks
- Assorted Waters (coconut water)
- Fresh Fruit cut in Plastic Containers
- Yogurt
- Grab & Go Sandwiches
- Grab & Go Green Salad
- Grab & Go Pasta Salad
- Granola in Plastic Containers
- Grab & Go Sweet Cakes in Plastic Containers

Self Serve Beverage

- 1) Coke Station
- 2) Tropical Ice Tea
- 3) Feature Other
- 4) Hot Water for Tea
- 5) Cold Water Station
- 6) Feta Urn Station for Fast Cup Coffee
- 7) Coffee Condiment Station (cream, sugars, sleeves, honey, lids, cups, stir)
- 8) Garbage
- 9) Trays
- Dry Goods at POS
- 1) Chips
- 2) Assorted Granola Bars
- 3) Assorted Chocolates
- 4) Java House Grab & Go Bars
- 5) Java House Grab & Go Cookies

POS

- Three Terminals
- To Go Packaging (plastic packets with napkins and bags)
- Gift Cards
- Order Online Information
- Condiment Station
- 1) Garbage
- 2) Napkins
- 3) Silverware
- 4) Mayo, mustard, salt & pepper
- 5) Special Order Information Area

FLOOR PLAN
3/16" = 1'-0"
PLAN NORTH